

# MXZ







SERIES



# SELECTION

Choose from four types of indoor units and eight outdoor units that can run up to eight indoor units each. Create the system that best matches room shapes and number of rooms.

STEP 1		SELECT INDOOR UNITS	
Select the indoor unit to be installed in each room.			
<div>Wall-mounted</div> <div></div>	<div>Floor-standing</div> <div></div>	<div>Cassette</div> <div></div>	<div>Ceiling-suspended</div> <div></div> <div>Ceiling-concealed</div> <div></div>

STEP 2		SELECT OUTDOOR UNITS	
Select the best outdoor unit based on the number of indoor units and overall system capacity required.			
<b>2-port</b> Connect up to 2 indoor units	<b>3-port</b> Connect up to 3 indoor units	<b>4-port</b> Connect up to 4 indoor units	<b>8-port</b> Connect up to 8 indoor units
 MXZ-2C30VA MXZ-2C40VA MXZ-2C52VA	 MXZ-3C54VA MXZ-3C68VA	 MXZ-4C71VA MXZ-4C80VA	<div><b>Outdoor Unit</b>  MXZ-8B140V(Y)A MXZ-8B160V(Y)A</div> <div><b>Branch Box</b>  PAC-AK31BC PAC-AK52BC</div> <p>Connection to indoor units requires an appropriate branch box (distribution piping is required when connecting two branch boxes).</p>
<b>5-port</b> Connect up to 5 indoor units	<b>6-port</b> Connect up to 6 indoor units		
 MXZ-5C100VA	 MXZ-6C120VA		

STEP 3		CHECK SYSTEM COMPATIBILITY	
Possible combinations depends on the outdoor unit chosen. Please check the following points.			
Check Indoor Units		Refer to the "Indoor Unit Compatibility Table" to check if the indoor units selected can be used with the outdoor unit selected. (Indoor units not listed in the table cannot be used.)	
Check Indoor Unit Capacity Combination		Refer to the "Combination Table" to check if the capacity combination of the indoor unit selected is connectable. (Combinations not listed cannot be connected.)	
If the desired combination cannot be found, please change either the indoor or outdoor unit to match one of the combinations shown in the tables.			

# MXZ SERIES

Advancements in the MXZ Series include efficiency and flexibility in system expansion capabilities. The best solution when requiring multi-system air conditioning needs.



8-port

MXZ-8B140VA Single Phase  
MXZ-8B140YA Three Phase  
MXZ-8B160VA Single Phase  
MXZ-8B160YA Three Phase



6-port

MXZ-6C120VA



4-port 5-port

MXZ-4C80VA  
MXZ-5C100VA



3-port 4-port

MXZ-3C54VA  
MXZ-3C68VA  
MXZ-4C71VA



2-port

MXZ-2C30VA  
MXZ-2C40VA  
MXZ-2C52VA

## EXAMPLE SYSTEM

Smaller MXZ 2, 3, 4, 5 and 6 ports  
(example of MXZ-6C120VA system)

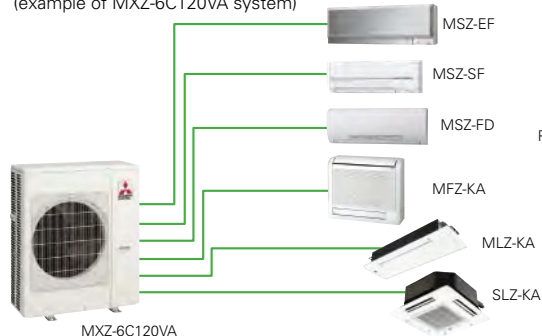

Power Multi MXZ-8B160VA

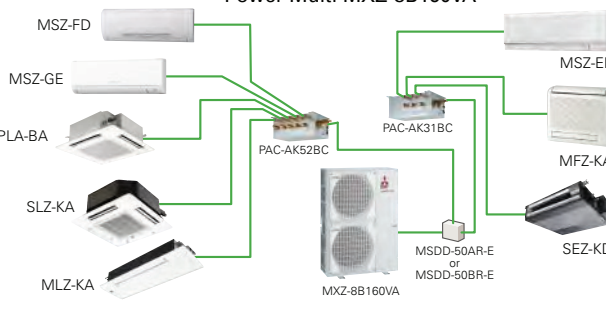

## Handle Up to 8 Rooms with a Single Outdoor Unit

The MXZ Series offers a 13-system line-up to choose from, ranging between 3.0 and 15.5kW. All of them are compatible with specific M, S and P series indoor units. A single outdoor unit can handle a wide range of building layouts.

## "Energy Rank A" for All Models



A rating of "Energy Rank A" has been achieved for all MXZ units owing to the incorporation of Mitsubishi Electric's cutting-edge inverter technologies.

## Support Functions

### Wiring/Piping Correction Function\* (4C80/5C100/6C120)

Simply press a single button to confirm if piping and wiring are properly connected. Wiring errors are corrected automatically when discovered. This eliminates the need to confirm complicated wiring connections when expanding the system. (For details, refer to the outdoor unit installation manual.)

\* Function cannot be used when the outdoor temperature is below 0°C. The correction process requires 10–20 minutes to complete and must be conducted with the unit set to the "Cooling" mode.

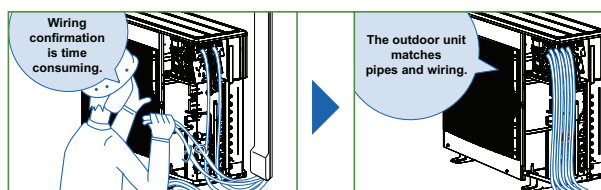

### Ampere Limit Adjustment (4C80/5C100/6C120/8B140)

Dipswitch settings can be used to adjust the maximum electrical current for operation. This function is highly recommended for managing energy costs. (For details, refer to the outdoor unit installation manual.)

\* Maximum capacity is lowered with the use of this function.

## Operation Lock

(2C/3C/4C/5C/6C/8B)

To accommodate specific use applications, cooling or heating operation can be specified when setting the control board of the outdoor unit. A convenient option when a system needs to be configured for exclusive cooling or heating service. (For details, refer to the outdoor unit installation manual.)



Type (Inverter Multi - Split Heat Pump)				Up to 2 Indoor Units			Up to 3 Indoor Units		Up to 4 Indoor Units		Up to 5 Indoor Units	Up to 6 Indoor Units
Model Name				MXZ-2C30VA	MXZ-2C40VA	MXZ-2C52VA	MXZ-3C54VA	MXZ-3C68VA	MXZ-4C71VA	MXZ-4C80VA	MXZ-5C100VA	MXZ-6C120VA
Power Supply [V / Phase / Hz , Source]				230 / Single / 50 , Outdoor power supply								
Cooling	Capacity	Rated	kW	3.0	4.0	5.2	5.4	6.8	7.1	8.0	10.0	12.0
		Min - Max	kW	1.1 - 4.0	1.1 - 4.5	1.1 - 6.0	2.9 - 6.8	2.9 - 8.4	3.7 - 8.8	3.7 - 9.2	3.9 - 11.0	3.5 - 13.5
	Input* <sup>1</sup>	Rated	kW	0.560	0.875	1.300	1.190	1.775	1.68	1.955	2.8	3.61
		EER* <sup>2</sup>		4.97	4.32	3.83	4.30	3.69	4.02	3.86	3.44	3.21
	EEL Rank			A	A	A	A	A	A	A	A	A
	SPL [Outdoor]	Rated - Silent	dB(A)	46 - 44	47 - 44	49 - 45	47 - 45	48 - 45	48 - 45	46 - 44	51 - 46	55 - 51
Air Volume [Outdoor]			m³/min	32.9	29.2	32.9	42.1	42.1	42.1	42.1	56.6	55.4
Heating	Capacity	Rated	kW	4.0	4.5	6.4	7.0	8.6	8.6	9.4	12.0	14.0
		Min - Max	kW	1.0 - 4.4	1.0 - 5.0	1.0 - 7.0	2.6 - 9.0	2.6 - 10.6	3.4 - 10.7	3.4 - 11.6	4.1 - 14.0	3.5 - 16.5
	Input* <sup>1</sup>	Rated	kW	0.815	0.870	1.610	1.465	2.05	1.705	1.93	2.835	3.47
		COP* <sup>2</sup>		4.65	4.91	3.86	4.56	4.06	4.79	4.65	4.07	3.88
	EEL Rank			A	A	A	A	A	A	A	A	A
	SPL [Outdoor]	Rated - Silent	dB(A)	47 - 46	48 - 47	50 - 48	51 - 48	52 - 48	52 - 48	48 - 46	54 - 47	57 - 53
Air Volume [Outdoor]			m³/min	31.3	26.6	33.3	43.0	43.0	43.0	43.8	59.3	69.9
Operating Current (max)* <sup>1</sup>			A	8.0	10.2	10.2	15.0	15.0	15.0	17.4	18.4	27.0
Total Capacity of all Indoor Units (max)			kW	See combination table								
Outdoor	Dimensions	Height	mm	550	550	550	710	710	710	900	900	1,070
		Width	mm	800	800	800	840 (+30)	840 (+30)	840 (+30)	900	900	900
		Depth	mm	285	285	285	330	330	330	320 (+30)	320 (+30)	320 (+21)
	Weight		kg	33	35	38	57	57	58	67	68	88
Ext. Piping	Diameter	Liquid	mm	6.35 x 2	6.35 x 2	6.35 x 2	6.35 x 3	6.35 x 3	6.35 x 4	6.35 x 4	6.35 x 5	6.35 x 6
		Gas	mm	9.52 x 2	9.52 x 2	9.52 x 2	9.52 x 3	9.52 x 3	9.52 x 3 + 12.7 x 1	9.52 x 3 + 12.7 x 1	9.52 x 4, 12.7 x 1	9.52 x 5 + 12.7 x 1
	Max. Length	Total / Out - In	m	20 / 15	30 / 20	30 / 20	50 / 25	60 / 25	60 / 25	70 / 25	80 / 25	80 / 25
	Max. Height	Out - In	m	10	15 (10)* <sup>3</sup>	15 (10)* <sup>3</sup>	15 (10)* <sup>3</sup>	15 (10)* <sup>3</sup>	15 (10)* <sup>3</sup>	15 (10)* <sup>3</sup>	15 (10)* <sup>3</sup>	15 (10)* <sup>3</sup>
Guaranteed Operating Range [Outdoor]			Cooling	℃	-10 ~ +43	-10 ~ +43	-10 ~ +43	-10 ~ +43	-10 ~ +43	-10 ~ +43	-10 ~ +43	-10 ~ +43
			Heating	℃	-15 ~ +24	-15 ~ +24	-15 ~ +24	-15 ~ +24	-15 ~ +24	-15 ~ +24	-15 ~ +24	-15 ~ +24

Type (Inverter Multi - Split Heat Pump)				Up to 8 Indoor Units			
Model Name				MXZ-8B140VA	MXZ-8B140YA	MXZ-8B160VA	MXZ-8B160YA
Power Supply	Source			Outdoor power supply			
	Outdoor [V / Phase / Hz]			VA:230 / Single / 50 , YA:400 / Three / 50			
Cooling	Capacity	Rated	kW	14.0	14.0	15.5	15.5
	Input * <sup>1</sup>		kW	3.79	3.79	4.64	4.64
	EER * <sup>2</sup>			3.52	3.52	3.21	3.21
		EEL Rank		— *	— *	— *	— *
	SPL [Outdoor]	Rated - Silent	dB(A)	50 - 47	50 - 47	51 - 48	51 - 48
	Air Volume [Outdoor]		m³/min	100	100	106	106
Heating	Capacity	Rated	kW	16.0	16.0	18.0	18.0
	Input * <sup>1</sup>		kW	3.90	3.90	4.80	4.80
	COP * <sup>2</sup>			3.91	3.91	3.61	3.61
		EEL Rank		— *	— *	— *	— *
	SPL [Outdoor]	Rated	dB(A)	52	52	54	54
	Air Volume[Outdoor]		m³/min	100	100	106	106
Total Capacity of All Indoor Units (max)			kW	18.5	18.5	20.2	20.2
Operating Current (max) * <sup>1</sup>			A	29.5	13.0	29.5	13.0
Breaker Size			A	40	25	40	25
Outdoor	Dimensions	Height	mm	1,350	1,350	1,350	1,350
		Width	mm	950	950	950	950
		Depth	mm	330	330	330	330
	Weight		kg	129	139	129	139
Ext. Piping	Diameter	Liquid	mm	9.52 x 1	9.52 x 1	9.52 x 1	9.52 x 1
		Gas	mm	15.88 x 1	15.88 x 1	15.88 x 1	15.88 x 1
	Max. Length	Total / Out - In	m	115 / 70	115 / 70	115 / 70	115 / 70
	Max. Height	Out - In	m	20 (30)* <sup>4</sup>	20 (30)* <sup>4</sup>	20 (30)* <sup>4</sup>	20 (30)* <sup>4</sup>
Guaranteed Operating Range [Outdoor]			Cooling	℃	-5 ~ +46	-5 ~ +46	-5 ~ +46
			Heating	℃	-15 ~ +21	-15 ~ +21	-15 ~ +21

\* Eurovent application not filed

Type				Branch Box		
Model Name				PAC-AK52BC*6	PAC-AK31BC	
Connectable Number of Indoor Units				Max. 5	Max. 3	
Power Supply	Source			Outdoor power supply		
	Outdoor [V / Phase / Hz]			VA:230 / Single / 50 , YA:400 / Three / 50		
Total Input			kW	0.003		
Operating Current			A	0.05		
Drain Hose Size*5			mm	O.D. 20 (VP - 16)		
Dimensions [HxWxD]			mm	198 - 450 - 280		
Weight			kg	9.3	8.1	
Piping [diameter]	Branch	Liquid	mm	6.35 x 5	6.35 x 3	
		Gas	mm	9.52 x 4, 12.7 x 1	9.52 x 3	
	Main	Liquid	mm	9.52		
		Gas	mm	15.88		
	Connection Method			Flared		
	Wiring	to Indoor Unit			3-wire + Earth wire	
to Outdoor Unit			3-wire + Earth wire			

\*1 ) Power Input and Operating Current (MAX) figures are for outdoor unit only.

\*2 ) EER and COP are the figures when connected to the indoor units listed below.

MXZ-2C30VA → MSZ-GE25VA x 2

MXZ-2C40VA → MSZ-GE25VA + MSZ-GE35VA

MXZ-2C52VA → MSZ-GE35VA x 2

MXZ-3C54VA → MSZ-GE25VA x 3

MXZ-3C68VA → MSZ-GE25VA x 3

MXZ-4C71VA → MSZ-GE25VA x 4

MXZ-4C80VA → MSZ-GE35VA x 4

MXZ-5C100VA → MSZ-GE25VA x 5

MXZ-6C120VA → MSZ-GE25VA x 6

MXZ-8B140VA/YA → MSZ-GE22VA x 8 + PAC-AK52BC + PAC-AK31BC

MXZ-8B160VA/YA → MSZ-GE25VA x 8 + PAC-AK52BC + PAC-AK31BC

\*3 ) If the outdoor unit is installed higher than the indoor unit, max. height is reduced to 10m.

\*4 ) If the outdoor unit is installed higher than the indoor unit, max. height is increased to 30m.

\*5 ) Drain hose is to be locally purchased.

\*6 ) With using PAC-AK52BC and PAC-AK52YP,PLA-RP100BA/BA3 can be connected to MXZ-8B 140V(Y)A / 160V(Y)A.

# Indoor Unit Compatibility Table

Possible combinations of outdoor units and indoor units are shown below.

Indoor Unit			Outdoor Unit		MXZ-										
			2C30VA	2C40VA	2C52VA	3C54VA	3C68VA	4C71VA	4C80VA	5C100VA	6C120VA	8B140VA	8B140YA	8B160VA	8B160YA
M series	Wall-Mounted	MSZ-FD25VA	●	●	●	●	●	●	●	●	●	●	●	●	●
		MSZ-FD25VAS	●	●	●	●	●	●	●	●	●	●	●	●	●
		MSZ-FD35VA		●	●	●	●	●	●	●	●	●	●	●	●
		MSZ-FD35VAS		●	●	●	●	●	●	●	●	●	●	●	●
		MSZ-FD50VA				●	●	●	●	●	●	●	●	●	●
		MSZ-FD50VAS				●	●	●	●	●	●	●	●	●	●
		MSZ-EF22VE(W)(B)(S)	●	●	●	●	●		●	●	●	●	●	●	●
		MSZ-EF25VE(W)(B)(S)	●	●	●	●	●	●	●	●	●	●	●	●	●
		MSZ-EF35VE(W)(B)(S)		●	●	●	●	●	●	●	●	●	●	●	●
		MSZ-EF42VE(W)(B)(S)			●	●	●	●	●	●	●	●	●	●	●
		MSZ-EF50VE(W)(B)(S)			●	●	●	●	●	●	●	●	●	●	●
		MSZ-GE22VA	●	●	●	●	●	●	●	●	●	●	●	●	●
		MSZ-GE25VA	●	●	●	●	●	●	●	●	●	●	●	●	●
		MSZ-GE35VA		●	●	●	●	●	●	●	●	●	●	●	●
		MSZ-GE42VA			●	●	●	●	●	●	●	●	●	●	●
		MSZ-GE50VA			●	●	●	●	●	●	●	●	●	●	●
		MSZ-GE60VA					●	●	●	●	●	●	●	●	●
		MSZ-GE71VA						●	●	●	●	●	●	●	●
		MSZ-SF15VA	●	●	●	●	●	●	●	●	●	●	●	●	●
	MSZ-SF20VA	●	●	●	●	●	●	●	●	●	●	●	●	●	
	Floor-Standing	MFZ-KA25VA	●	●	●	●	●	●	●	●	●	●	●	●	●
		MFZ-KA35VA		●	●	●	●	●	●	●	●	●	●	●	●
		MFZ-KA50VA				●	●	●	●	●	●	●	●	●	●
	1-way Cassette	MLZ-KA25VA	●	●	●	●	●	●	●	●	●	●	●	●	●
		MLZ-KA35VA		●	●	●	●	●	●	●	●	●	●	●	●
		MLZ-KA50VA				●	●	●	●	●	●	●	●	●	●
S series	4-way Cassette	SLZ-KA25VAQ	●	●	●	●	●	●	●	●	●	●	●	●	●
		SLZ-KA25VAL	●	●	●	●	●	●	●	●	●	●	●	●	●
		SLZ-KA35VAQ		●	●	●	●	●	●	●	●	●	●	●	●
		SLZ-KA35VAL		●	●	●	●	●	●	●	●	●	●	●	●
		SLZ-KA50VAQ				●	●	●	●	●	●	●	●	●	●
		SLZ-KA50VAL				●	●	●	●	●	●	●	●	●	●
	Ceiling-Conceald	SEZ-KD25VAQ	●	●	●	●	●	●	●	●	●	●	●	●	●
		SEZ-KD25VAL	●	●	●	●	●	●	●	●	●	●	●	●	●
		SEZ-KD35VAQ		●	●	●	●	●	●	●	●	●	●	●	●
		SEZ-KD35VAL		●	●	●	●	●	●	●	●	●	●	●	●
		SEZ-KD50VAQ				●	●	●	●	●	●	●	●	●	●
		SEZ-KD50VAL				●	●	●	●	●	●	●	●	●	●
		SEZ-KD60VAQ					●	●	●	●	●	●	●	●	●
		SEZ-KD60VAL					●	●	●	●	●	●	●	●	●
		SEZ-KD71VAQ						●	●	●	●	●	●	●	●
		SEZ-KD71VAL							●	●	●	●	●	●	●
P series	4-way Cassette	PLA-RP35BA									●	●	●	●	
		PLA-RP50BA				●	●	●	●	●	●	●	●	●	
		PLA-RP60BA					●	●	●	●	●	●	●	●	
		PLA-RP71BA2						●	●	●	●	●	●	●	
		PLA-RP71BA						●	●	●	●	●	●	●	
		PLA-RP100BA/BA3									●*	●*	●*	●*	
	Ceiling-Suspended	PCA-RP50KAQ				●	●	●	●	●	●				
		PCA-RP60KAQ					●	●	●	●	●				
		PCA-RP71KAQ							●	●	●				

\* PAC-AK52YP-E and PAC-AK52BC are required.

## Conditions for specifications

Temperature conditions are based on JIS B8616.

Cooling	Indoor	27°C DB, 19°C WB
	Outdoor	35°C DB
Heating	Indoor	20°C DB
	Outdoor	7°C DB, 6°C WB

Refrigerant piping length ; 5m

The figures for total input are based on the following voltages.

Series	Indoor unit	Outdoor unit
M Series (except for MSH,MS) S Series P Series (except for PEA) MXZ Series POWER HEATING Series	-	VA,VHA,VKA:230V/Single phase/50Hz YA,YHA,YKA:400V/Three phase/50Hz
MSH,MS Series	230V/Single phase/50Hz	230V/Single phase/50Hz
PEA Series	400V/Three phase/50Hz	400V/Three phase/50Hz

Sound pressure level

- The sound pressure measurement is conducted in an anechoic chamber.
- The actual sound level depends on the distance from the unit and the acoustic environment.

## How to read a model name

### 1) M & S Series

M	M : M Series S : S Series
S	"S"= Wall-mounted , "F"= Compact floor-standing , "E"= Compact ceiling-concealed , "L"= 4- or 1-way cassette , "U"= Outdoor unit
Z	"Z"= Inverter heat pump , "H"= Fixed-speed heat pump , "none"= Cooling only
-	
F	Series
D	Generation
25	Rated cooling capacity (kW base)
V	230V / Single phase / 50Hz
A	"A"= R410A with new A control , "B"= R410A with conventional control , "E"= R410A with new A control & ErP correspondance
H	"H"= Anti-freeze heater equipped model , "S"= Silver indoor unit , "W"= White indoor unit , "B"= Black indoor unit

### 2) P Series

P	P Series
U	"K"= Wall-mounted , "S"= Floor-standing , "L"= 4-way cassette , "E"= Ceiling-concealed , "C"= Ceiling-suspended , "U"= Outdoor unit
H	"H"= For heating and cooling , "blank"= Cooling only
Z	"Z"= Inverter , "blank"= Fixed-speed
-	
H	"H"= Powerful heating ZUBADAN , "blank"= Other series
RP	"RP"= R410A & cleaning-free pipe reuse , "P"=R410A
71	Rated cooling capacity (kW base)
V	"V"= 230V / Single phase / 50Hz , "Y"= 400V / Three phase / 50Hz
H	Generation
A	"A"= A control

### 3) MXZ Series

M	M Series
X	Multi-system outdoor unit (heat pump)
Z	Inverter heat pump
-	
4	Maximum number of connectable indoor units
C	Generation
71	Rated cooling capacity (kW base)
V	"V"= 230V / Single phase / 50Hz , "Y"= 400V / Three phase / 50Hz
A	"A"= R410A with new A control